

FORM No. 1.

Bear Dis N S E W E D. W D. Med. Area South  
 N79E 48 9.2 47.1 3 3 28  
 N6W 29 28.8 3 44.1 47.1 1356  
 S49 1/4 W 58.3 38 44.1 47.1 00.0

38 38 47.1 47.1 47.1 47.1 2/1384  
 1096 6920 1405  
 6784  
 1067 136 (13 pers)  
 106  
 300

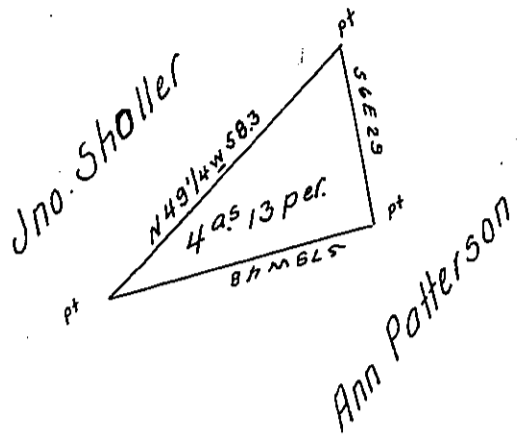

Draft of a Small tract of land Situate in Dickinson Twp. (now Penn) Cumberland Co. Surveyed under War<sup>t</sup> to Ann Patterson Dated Oct. 2<sup>nd</sup> 1832 for 3<sup>as</sup> of unimproved - A Copy of the original remaining on file was sent to me dated July 6<sup>th</sup> 1870. And Survey made July 18<sup>th</sup> 1870.

J. C. Eckels  
 County Surveyor

IN TESTIMONY that the above is a copy of the original remaining on file in the Department of Internal Affairs of Pennsylvania, made conformably to an Act of Assembly approved the 16th day of February, 1833, I have hereunto set my Hand and caused the Seal of said Department to be affixed at Harrisburg, this ninth day of May 1906.

*Isaac B. Brown*  
 Secretary of Internal Affairs.